

new art laboratories



Reactif

Urinalysis strips and evaluation devices

Automated testing – fast, semi-quantitative analysis



Reactif urinalysis strips

Test strips

Reactif urinalysis strips provide the fast and reliable results you need for a targeted diagnosis. They offer you the highest quality and the opportunity to benefit from a more cost-effective alternative to expensive laboratory evaluations. The reagent strips for urinalysis are solid plastic strips to which several sep-

arate reagent fields are applied. The test provides the qualitative and semi-quantitative detection of one or more analytes in urine. To interpret the test results, compare the relevant analyte with the colour scale fields on the test strip container.

Your benefits at a glance

- ✓ Clear colour change in clinical decision-making range
- ✓ Fast and reliable test results in just 1 minute
- ✓ Simultaneous testing of up to 14 parameters
- ✓ Functionality indicator shows adulteration through vitamin C in urine
- ✓ Cost-effective diagnosis
- ✓ Long shelf life: 24 months, or 3 months after opening
- ✓ Controls available in small, cost-effective pack sizes

Urinalysis

Urine test strips are a modern medical aid that allows information about urine status and any pathological changes in the organism to be gathered quickly, simply and without significantly increasing the workload. This means targeted diagnostics can be carried out quickly and effective treatment for a wide variety of clinical pictures can be initiated.

The test strips are designed in such a way that even minor pathological changes in the urine are indicated by a clear colour change in the test fields. They have a wide range of applications in routine examinations, preventative health check-ups and treatment/relapse monitoring.

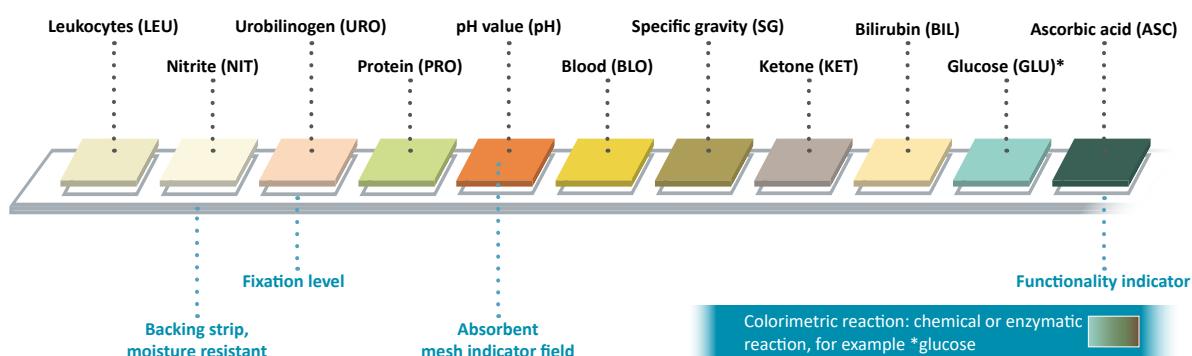

Test procedure:

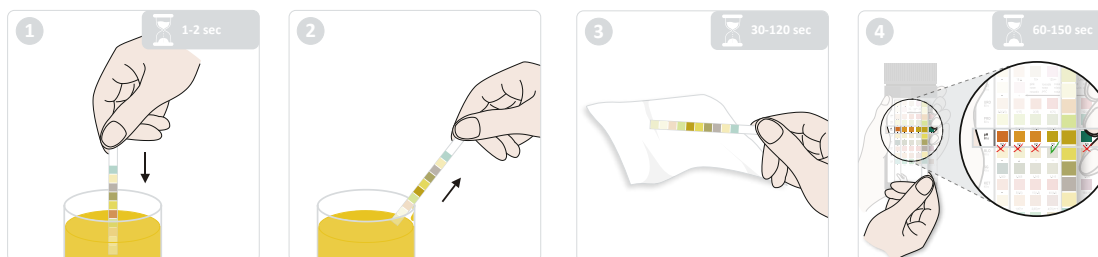

More detailed information can be found in the instructions for use.

Controls

nal von minden GmbH offers controls for all Reactif urinalysis strips in small, practical pack sizes. Their purpose is to verify visually-interpreted and

machine-interpreted urinalyses. The liquid urine control is available in 2 concentrations and is ready to use for the routine monitoring of urinalyses.

Parameters available:

✓ Ascorbic acid	✓ Glucose	✓ pH value
✓ Bilirubin	✓ Ketone	✓ Protein
✓ Blood	✓ Leukocytes	✓ Specific gravity
✓ Calcium	✓ Microalbumin	✓ Urobilinogen
✓ Creatinine	✓ Nitrite	

Parameter overview

Parameter	Sensitivity (with Reactif Touch urinalysis device)	Parameter can be indicative of (e.g.*)
Ascorbic acid (ASC)	From 8 - 10 mg/dL (0.45 - 0.56 mmol/L)	<ul style="list-style-type: none"> ✓ Potential interference with the following parameters: blood, bilirubin, nitrite and glucose
Bilirubin (BIL)	From 0.8 - 1.0 mg/dL (13.6 - 17 µmol/L)	<ul style="list-style-type: none"> ✓ Impairment of the liver, e.g. through cirrhosis, hepatitis or fatty liver disease ✓ Bile duct occlusion ✓ Increased haemolysis ✓ Medication side effects
Blood (BLO)	From 0.018 - 0.060 mg/dL or 5 - 10 Ery/µL with an ascorbic acid content of <50 mg/dL	<ul style="list-style-type: none"> ✓ Kidney or urogenital tract diseases ✓ Blood clotting disorder ✓ Endometriosis or prostate disease
Calcium (CA)	Between 4 mg/dL (1.0 mmol/L) and 40 mg/dL (10 mmol/L)	<ul style="list-style-type: none"> ✓ Disruption in the body's calcium balance, e.g. in osteoporosis ✓ Tumour ✓ Vitamin A or vitamin D overdose
Creatinine (CRE)	Between 10 and 300 mg/dL (0.9 mmol/L and 26.5 mmol/L)	<ul style="list-style-type: none"> ✓ Acute or chronic kidney disease ✓ Increased creatine intake
Glucose (GLU)	From 80 - 100 mg/dL (4 - 5 mmol/L)	<ul style="list-style-type: none"> ✓ Metabolic disease (diabetes) ✓ Kidney function ✓ Complications during pregnancy
Ketone (KET)	From 4 - 5 mg/dL (0.4 - 0.5 mmol/L)	<ul style="list-style-type: none"> ✓ Alcohol abuse (alcoholic ketoacidosis) ✓ Diabetes mellitus type 1 (ketoacidosis) ✓ Severe physical strain, fasting ✓ Lactic acidosis
Leukocytes (LEU)	From min. 12 - 15 white blood cells (leu/µL) in clinical urine	<ul style="list-style-type: none"> ✓ Infection of the urinary tract, genitals or kidneys ✓ Frequently occurs in conjunction with blood, proteinuria, nitrite and high pH
Microalbumin (ALB)	From 20 - 30 mg/L	<ul style="list-style-type: none"> ✓ Kidney dysfunction ✓ Diabetic nephropathy

* Illustrative information, no liability assumed; deviating values can have a wide variety of causes that need to be clarified through differential diagnosis.

Parameter	Sensitivity (with Reactif Touch urinalysis device)	Parameter can be indicative of (e.g.*)
Nitrite (NIT)	From 0.05 mg/dL in urine with a low specific gravity and less than 30 mg/dL ascorbic acid	<ul style="list-style-type: none"> ✓ Bacterial urinary tract infection ✓ A negative result does not rule out a urinary tract infection ✓ Inflammation of the bladder or renal pelvis
pH value (pH)	Quantitative between pH 5 and 9	<ul style="list-style-type: none"> ✓ Changes in diet, medication or psychological factors ✓ Orientation of acid-base balance ✓ Alkalinisation: Urinary tract infection ✓ Hyperacidity: Urinary stones, gout, diabetes
Protein (PRO)	From 12 - 15 mg/dL (0.125 - 0.150 g/L)	<ul style="list-style-type: none"> ✓ Heavy physical exertion, pregnancy or fever ✓ Disease of the kidneys and urinary tract
Specific gravity (SG)	Between 1.000 and 1.030	<ul style="list-style-type: none"> ✓ Urine concentration (dependant on fluid intake and output and the kidneys' ability to concentrate urine) ✓ Diuresis due to diuretic agents such as tea or medications ✓ Nephrogenic diabetes insipidus ✓ Pathological relevance of borderline results
Urobilinogen (URO)	From 0.8 - 1.0 mg/dL (13.6 - 17 µmol/L)	<ul style="list-style-type: none"> ✓ Acute and chronic diseases, liver dysfunction ✓ Toxic liver damage ✓ Haemolytic diseases

* Illustrative information, no liability assumed; deviating values can have a wide variety of causes that need to be clarified through differential diagnosis.

Product overview: Reactif urinalysis strips

Product	Parameter														Tests/ pack	Order number	Auto- mated analysis	
Reactif G						G										100	41010-L	
Reactif GP						G							P			100	41020-L	✓
Reactif 2					C				Ma							50	41021-M	✓
Reactif 2B						G	K									100	41022-L	
Reactif 3						G					pH	P				100	41030-L	✓
Reactif 4			Bl			G					pH	P				100	41040-L	
Reactif 4B						G		L		N		P				100	41042-L	✓
Reactif 5B			Bl			G	K				pH	P				100	41050-L	
Reactif 5N			Bl			G		L		N		P				100	41051-L	
Reactif 7			Bl			G	K	L		N	pH	P				100	41070-L	✓
Reactif 8SG			Bl			G	K	L		N	pH	P	S			100	41080-L	✓
Reactif 9		Bi	Bl			G	K			N	pH	P	S	U		100	41090-L	✓
Reactif 10SL		Bi	Bl			G	K	L		N	pH	P	S	U		100	41101-L	✓
Reactif 11M	A	Bi	Bl			G	K	L		N	pH	P	S	U	100	41110-L	✓	
															25	41110-S		
Reactif 13	A	Bi	Bl		C	G	K	L	Ma	N	pH	P	S	U	25	41130-S	✓	
Reactif 14	A	Bi	Bl	Ca	C	G	K	L	Ma	N	pH	P	S	U	50	41140-M	✓	
Reactif Level 1 & 2 control kit (positive and negative; 5 mL each)		Bi	Bl		C	G	K	L	Ma	N	pH	P	S	U	Kit	41008		

A = ascorbic acid, Bi = bilirubin, Bl = blood, Ca = calcium, C = creatinine, G = glucose, K = ketone, L = leukocytes, Ma = microalbumin, N = nitrite, pH = pH value, P = protein, S = specific gravity, U = urobilinogen



Reactif Touch urinalysis devices

The right device for every need

The Reactif Touch urinalysis devices are semi-automatic reflection photometers that analyse the colour intensity of the reaction fields on the urine test strips and interpret them semi-quantitatively. The intuitive

and easy-to-read touchscreen can be successfully used after just a brief orientation process. Results are saved automatically and a result report produced for each test performed.

Your benefits at a glance

- ✓ Analysis of 15 different test strips with 1-14 different parameters
- ✓ Test modes: routine, STAT and QC
- ✓ Large, easy-to-read touch display
- ✓ Automatic calibration
- ✓ Easy to clean
- ✓ Internal printer for up to 3 copies per test (optional: sticker printing for quick and easy evaluation administration)
- ✓ Languages: multiple
- ✓ Memory: 2000 results (automatic)
- ✓ Simple data transfer and connection to LIS or external computer
- ✓ Barcode reader (optional)



Large, clear touch display



Removable and easy-to-clean test strip holder



Reactif Touch

Urinalysis device

Product overview

Product	Product code	Pack size
Reactif Touch urinalysis device		
Reactif Touch urinalysis device	41300	1
Reactif Touch urinalysis device incl. barcode scanner	41301	1
Reactif Touch barcode scanner	41305	1
Reactif Touch data transfer cable (incl. RS 232C Y-splitter data transfer cable)	41306	1
Accessories		
Printer paper roll	41105	4 units

- ✓ Throughput: up to 120 urine test strips per hour
- ✓ Perfectly suited for GP practices and smaller laboratories

Technical data

Specification	
Methodology	Modern imaging technology
Detection	CMOS image sensor
Throughput	Single test mode: 55 tests/hour Continuous analysis: 120 tests/hour
Measurement cycle	Continuous analysis: 30 seconds/test
Storage	2000 patient results, 800 users
Incubation period	1 minute
Ports	RS232C, 2 x USB port, SD card
Resources	Internal thermal printer (included) RS232C barcode reader (optional) USB or RS232C data transfer cable (optional) Ethernet via USB to RJ45 adapter (not included) Keyboard (not included)
Printer	Integrated or external Sequence of parameters can be chosen Thermal paper or adhesive labels
Data transfer	RS232C, LAN, WLAN
Calibration	Automatic before each measurement
Locks	User lock / QC lock
Barcodes	Amongst others Code 39, Codabar (NW-7), Code 128, EAN13/128, Interleave 2/5
Languages	German, English, Polish, Spanish, French, Danish, Italian, Portuguese, Czech, Romanian, Slovenian
Analyser operating conditions	0 - 40 °C, < 80 % relative humidity (non-condensing)
Test strip operating conditions	15 - 30 °C, < 85 % relative humidity (non-condensing)
Power source	6 AA alkaline batteries 100 - 240 V, 46 - 65 Hz Power saving mode
Weight	< 1.66 kg without batteries or power supply unit
Dimensions (LxWxH)	260 mm x 150 mm x 175 mm
Display	LCD touchscreen 116.8 mm x 88 mm (4.6" x 3.5")
Quality assurance	Test strip lot incl. expiry date User ID
Test mode	Routine analysis Emergency test QC mode
Result display	Conventional SI User-selected



Test strips are automatically detected, fed into the reader and evaluated.



Waste tray for used test strips.



Reactif Touch plus

Urinalysis device

Product overview

Product	Product code	Pack size
Reactif Touch plus urinalysis		
Reactif Touch plus urinalysis device	41302	1
Reactif Touch plus urinalysis device incl. barcode scanner	41303	1
Reactif Touch plus barcode scanner	41304	1
Reactif Touch plus data transfer cable (incl. RS 232C Y-splitter data transfer cable)	41307	1
Accessories		
Printer paper roll	41105	4 units

- ✓ Throughput: up to 500 urine test strips per hour
- ✓ Automatic test strip detection and alignment for higher efficiency
- ✓ Test strips are automatically fed into the device and afterwards disposed of in the waste tray
- ✓ Perfectly suited for clinics and large laboratories

Technical data

Specification	
Methodology	Reflection photometer
Detection	Photosensitive diode
Throughput	500 tests/hour
Measurement cycle	7 seconds/test
Storage	2000 patient results, 10 users
Incubation period	1 minute
Ports	RS232C, USB port, printer port
Resources	Internal thermal printer (included) External printer (not included) RS232C barcode scanner (optional) RS232C data transfer cable (optional) USB data transfer cable (not included)
Printer	Integrated or external Sequence of parameters can be chosen Thermal paper or adhesive labels
Data transfer	RS232C, USB
Calibration	Automatic before each measurement
Locks	User lock/QC lock
Barcodes	Amongst others Code 39, Codabar (NW-7), Code 128, EAN13/128, Interleave 2/5
Languages	German, English, Polish, French, Spanish, Portuguese, Italian
Analyser operating conditions	0 - 40 °C, <85 % relative humidity (non-condensing)
Test strips operating conditions	15 - 30 °C, <85 % relative humidity (non-condensing)
Power source	100 - 240 V, 50 - 60 Hz
Weight	4.0 kg
Dimensions (LxWxH)	36.6 cm x 28.3 cm x 19.5 cm
Display	Colour touchscreen 115 mm x 90 mm (4.5" x 3.5")
Quality assurance	Test strip lot incl. expiry date User ID
Test mode	Routine analysis Emergency test QC mode
Result display	Conventional SI User-selected